



### Area of Application:

Reservoir installation for direct suction line connection

### Characteristics:

- Suitable for mineral oil
- Threads forms BSP and NPT
- Filter material 60, 125 or 250 micron stainless steel
- Temperature range  $-20^{\circ}\text{C} \dots +100^{\circ}\text{C}$
- Optional bypass valve, opening pressure 0,2 bar (3 PSI)
- Threaded end caps made out of glass fiber reinforced Polyamide (P) or Aluminium (A) (see table below), other components steel zinc-plated

**STAUFF-Suction Strainers SUS are available with an integrated bypass valve. Other special configurations on request.**

### Dimensions

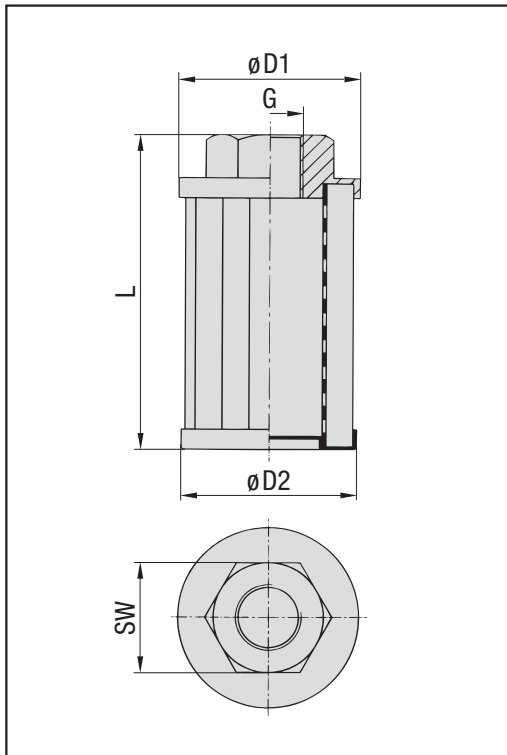

Group size ø upper endcap	thread- code	element- length	Dimensions				Q max l/min	available end cap material					
			D1	D2	G	SW			L				
040	B06F	075	39,5	38,5	3/8 BSP	22	75	8	P				
050	B06F	067	50	49	3/8 BSP	26	67	10	P				
050	N06F	067			3/8 NPT				90	11	P		
050	N06F	090			1/2 BSP				105	15	P		
050	B08F	105			1/2 NPT						A,P		
068	B12F	105	68	66	3/4 BSP	34	105	25	P				
068	N12F	105			3/4 NPT				A,P				
068	B16F	140			42	140	50	P					
068	N16F	140						1 NPT	A,P				
088	B20F	140	88	85	1 1/4 BSP	50	140	65	P				
088	N20F	140			1 1/4 NPT				A,P				
088	N20F	195			60	140	95	226	120	P			
088	B24F	140								1 1/2 BSP	A,P		
088	N24F	140								1 1/2 NPT	260	198	A
088	N24F	260											A,P
088	N32F	260	102	100	2 NPT	70	200	200	A				
102	B24F	200			1 1/2 BSP				P				
102	N24F	200			1 1/2 NPT				P				
102	B32F	200			2 BSP				72	225	225	P	
102	B32F	225										P	
102	B32F	260										P	
102	B32F	300	P										
102	N32F	260	2 NPT	260	260	P							
131	B40F	191	131	128	2 1/2 BSP	86	191	290	P				
131	N40F	212							2 1/2 NPT	212	300	P	
131	B48F	272			3 BSP	96	272	380	P				
131	N48F	272							3 NPT	P			
150	B32F	151	150	145	2 BSP	70	151	260	P				
150	N40F	213			2 1/2 NPT				90	213	283	A	
150	N48F	272			3 NPT	100	272	380	A				

### Hydraulic Symbol

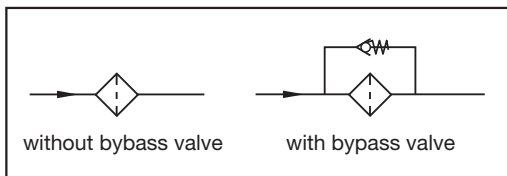

### Ordering Code

**SUS - P - 088 - B24F - 140 - 125 - 0**

<b>Typ</b> SUS Suction Strainer	<b>Bypass Option</b> 0 without bypass (standard) 3 integrated bypass valve (0,2 bar / 3 PSI)
<b>Material Threaded End Cap</b> P glass fiber reinforced Polyamide (standard) A Aluminium (only for NPT thread, see table)	<b>Micron Rating</b> 060 60 µm (on request) 125 125 µm (standard) 250 250 µm (on request)
<b>Group Size</b> see table above, column group size	